

User's Manual

HDR-1003S

The default password is 1234.

Contents

Contents & Accessories.....	2
Contents	
Accessories	
Quick Start Guide	3
Front	
Rear	
Remote Control	
Connections	
Wizard	
Programme Information (i-Plate)	
Channel List	
Edit Channels	
TV Guide.....	12
Recording & Playback.....	14
Recording	
Playback	
Media List	20
HUMAX TV Portal.....	25
Preferences	26
Installation	27
Search Channels [Fixed Antenna]	

Search Channels [SCD Antenna]	
Search Channels [Motor Antenna]	
Factory Default	
System	31
Appendix.....	33
Specification	
Trouble Shooting	
HUMAX Australia Customer Support	
Error Messages	
Using the Universal Remote Control	

Accessories

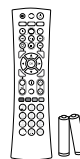

Remote Control
/ Batteries



User's Manual



RCA Cable



Power Cord



VAST Flyer_1



VAST Flyer_2



Screws

Front

Warning: Do not remove or insert the HDD Cartridge when the Power is "On". Refer to the next section, under heading 'Detaching the HDD Cartridge' and 'Attaching the HDD Cartridge'.

Note:

- The image may differ from the actual product.
- Use HDD cartridges provided by HUMAX only. HUMAX is not responsible for any damages caused by connecting unauthorised HDDs.

HDR-1003S/500GB

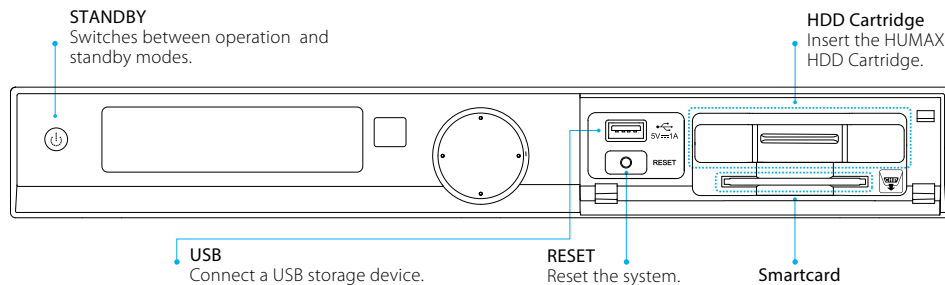

HDR-1003S/NOHDD

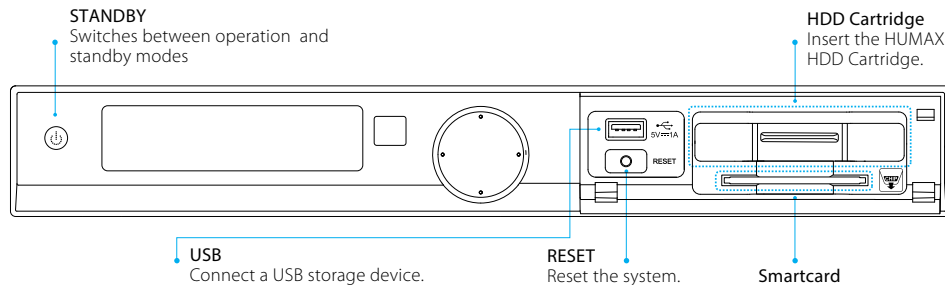

Inserting the Smartcard

1. Hold the Smartcard horizontally with the electronic chip facing downwards.
2. Insert the Smartcard into the slot.

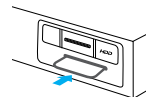

Detaching the HDD Cartridge

1. Turn off the power.
2. Press down the HDD cartridge gently until you hear a clicking sound.
3. Keep pressing down and pull out the HDD cartridge.

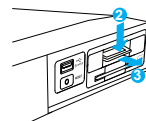

Attaching the HDD Cartridge

1. Turn off the power.
2. Push in the HDD cartridge until you hear a clicking sound.

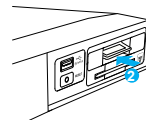

Note: If you attach a HUMAX HDD cartridge during operation, the system may reboot automatically.

Rear

HDR-1003S/500GB & NOHDD

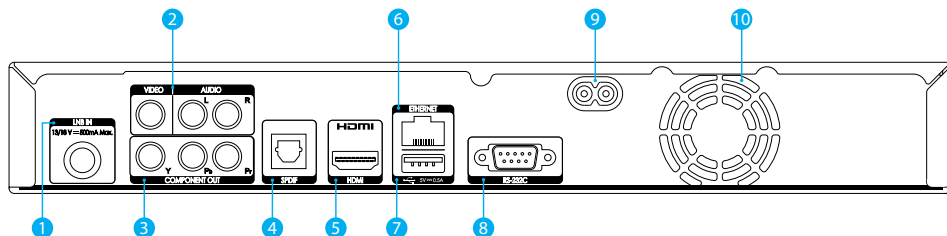

- 1 **LNB IN:** Connect a satellite antenna cable.
- 2 **VIDEO/AUDIO:** Use an RCA cable to connect to the TV.
- 3 **COMPONENT OUT:** Use a component cable to connect to the TV.
- 4 **SPDIF:** Use an SPDIF cable to connect to the digital audio device.
- 5 **HDMI:** Use an HDMI cable to connect to the TV.
- 6 **Ethernet:** Connect a LAN cable.
- 7 **USB:** Connect a wireless USB dongle or external USB devices.
- 8 **RS232C:** Connect to the PC to update software.
- 9 **POWER:** Connect the power cord.
- 10 **FAN:** Do not block.

Remote Control

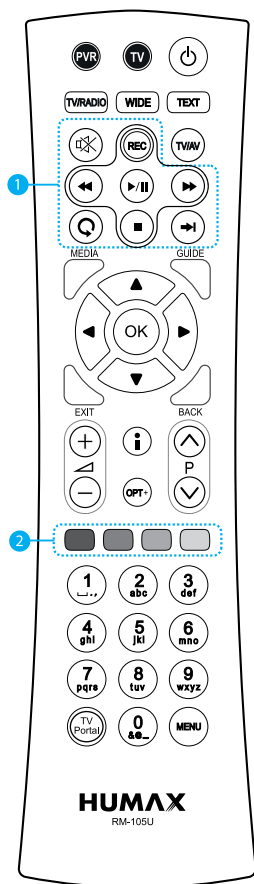

	PVR	Switches to PVR mode
	TV	Switches to TV mode
	STANDBY	Switches between operation and standby modes
	TV/RADIO	Switches between TV and radio modes
	WIDE	Sets the display format
	TEXT	Enters the digital text service
	MUTE	Mutes audio
1	Playback Control Buttons	REC Record, Rewind, Fast Forward, Play/Pause, Stop, Instant Replay, Skip
	TV/AV	Changes the video resolution
	MEDIA	Displays the media list
	GUIDE	Displays the programme guide
	EXIT	Exits all On-Screen Display (OSD) screens
	BACK	Returns to the previous menu
	OK	Selects a menu or confirms
	ARROW Buttons	Moves the cursor up, down, left or right
	VOL +/-	Changes the audio volume
	P	Changes the channel or page

	i (information)	Displays the channel and programme information
	OPT+ (Option)	Displays the channel attributes or additional options.
2	COLOUR Buttons	For interactive applications
	NUMERIC	(0-9)
	TV Portal	Goes to HUMAX TV Portal
	MENU	Displays the main menu

Inserting Batteries

Insert the batteries matching the positive(+) and negative (-) at each end.

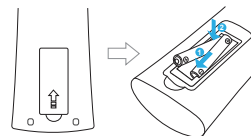

Connections

This section describes how to connect your product to match your particular devices and to gain optimum signal quality.

Warning: Connect all devices before you plug any power cords into the wall outlet. Always turn off the product, TV and other devices before you connect or disconnect any cables.

Note: If you encounter any problems setting up your product, please contact HUMAX Australia Customer Service.

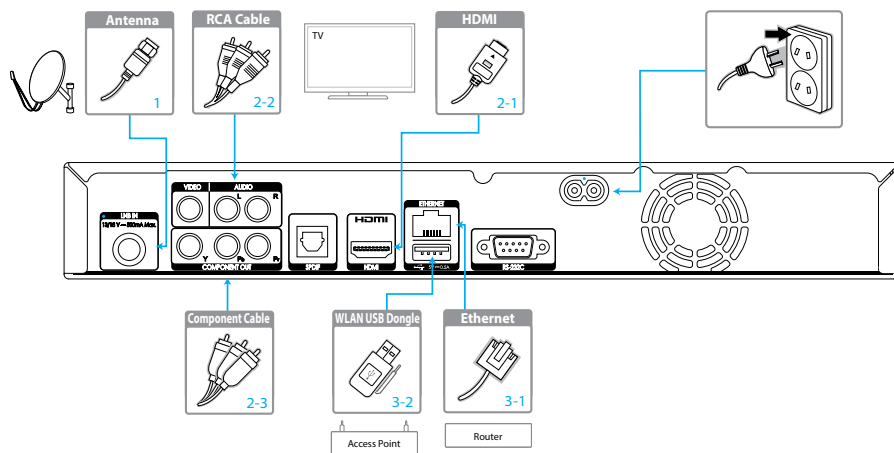

Connecting the Antenna

Connect the satellite antenna cable to the LNB IN.

Connecting the TV

2-1 Using an HDMI cable

For the best picture quality, use an HDMI cable to connect to the TV.

2-2 Using an RCA cable

For good picture quality, use an RCA cable to connect to the TV.

2-3 Using a component cable

For very good picture quality, use a component cable to connect to the TV.

Note:

- Use an S/PDIF cable to connect to the audio system for digital audio.

Connecting the Network

3-1 Connecting to the LAN

1. Use the Ethernet cable to connect the product and the LAN router.
2. Set the options for the LAN.
(Refer to **System>Internet Setting** for details.)

Note: We recommend the network connection over a direct LAN.

Quick Start Guide

3-2 Connecting to the Wi-Fi

1. Plug the HUMAX wireless USB dongle into rear USB port. (Separate purchase required)
2. Set the options for the Wi-Fi. (Refer to **System>Internet Setting** for details.)

Note:

- Make sure that the distance between the Wi-Fi access point and the product is not too far away. This may lower the quality of service.

Powering On

1. Connect the power cord of the product to a wall outlet.
2. Power on by pressing the **STANDBY** button on the remote control or the **STANDBY** button on the front panel of the product

Wizard

The installation wizard operates automatically when you power on the product for the first time or do factory default in menu.

Note: If you exit the installation wizard without fully completing the channel searching procedure, you may not have all of the channels available. In this case, go to **MENU > Settings > Installation** and search for more channels.

1. Region

Select the state you currently live in.

2. Display

Set the video output to your TV.

3. Search Channels

- Automatic Search: Search all channels automatically.
- Skip: If you have SCD or motor antenna, skip the search process and go to **MENU > Settings > Installation**.

4. Bouquet List

Select a Bouquet from the list.



5. Result

The result of the installation wizard will show. Select **Finish** to exit the wizard.



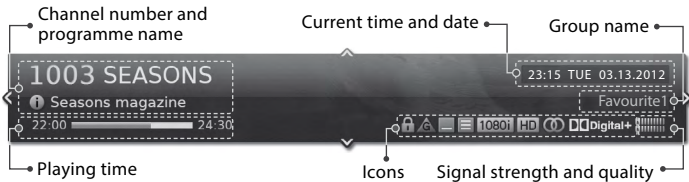





Programme Information (i-Plate)

The i-plate is an information banner that is displayed for a few seconds whenever you change channels. Press the **i** button while you watch a programme to display the i-plate. Press the **Exit** button on the remote control to hide it.

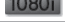
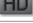

	Viewing detailed programme information Press the i button again while the i-plate is displayed.
	Viewing Previous/next programme information Press the ◀▶ button while the i-plate is displayed. Press the OK button to set reminders or recordings for future programmes.
	Viewing Programme information of other channels Press the ▲/▼ button while the i-plate is displayed. Press the OK button to change to the selected channel.

Icons

	Locked Programme
	Pay TV / encrypted programmes (CAS icons)
	Parental guidance programme
	Subtitle
	Dolby Digital audio
	Dolby Digital Plus audio
	Teletext
	Resolution
	HD programme
	Multiaudio

Note: Setting recordings is available only when the HUMAX HDD Cartridge is connected for recording.

Channel List

You can access the channel list in several ways.

- Press the **OK** button.
- Press the **MENU** button and select **Channel List**.

Changing Channels

Select the channel you want to watch and press the **OK** button. The channel will change.

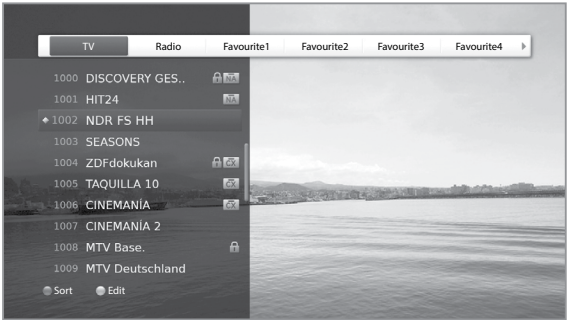

Note:

- : Locked channel, : Scrambled channel (CAS icons)
- Press the **i** button to view the detailed channel information.
- Press the **OK** or **EXIT** button to exit.
- Press the **TV/RADIO** button to switch between **TV** and **Radio** groups.

Editing Channels in Channel List

Select a channel you want to edit and press the **GREEN** button.

Favourite	Setting Favourite Channels Select a favourite group you want to move the channel to and press the OK button. To remove a channel from a favourite group, select the group and press the OK button again.
Lock	Locking Channels Select On or Off .

Note:

- The default password is 1234. If you have forgotten your password, please contact Humax Australia Customer Service.
- To edit multiple channels, go to **MENU > Settings > Edit Channels**.

	Changing Group Press the ► button to display the list of the selected channel group. (Radio, Favourite 1~5, Recent)
 RED	Sorting Channels Press the RED button to sort the channels in numerical or alphabetical order.

Edit Channels

Editing Channel List

MENU > Settings > Edit Channels > Password > Edit Channel List

Edit Channel List will help you lock or select multiple channels.

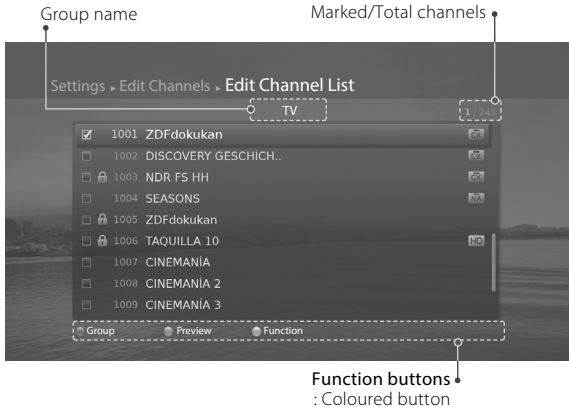

Note:

- : Locked channel, : Scrambled channel (CAS icons)
- Press the **TV/RADIO** button to switch between **TV** and **Radio** groups.
- Press the **MENU** or **EXIT** button to exit. Press the **BACK** button to return to the previous menu.
- The channels that are automatically numbered by the broadcaster cannot be deleted or moved.
- The default password is 1234.

 RED	Changing Group To list the channels of other groups, press the RED button and select a group you want.
 GREEN	Changing Background You can change the channel displayed in the background while editing. Select the channel you want to watch and press the GREEN button.
 YELLOW	Locking / Unlocking Channels Selecting / Releasing All Channels

Editing Favourite List

MENU > Settings > Edit Channels > Password > Edit Favourite List

Edit Favourite List will help you add or remove channels from the favourite groups.

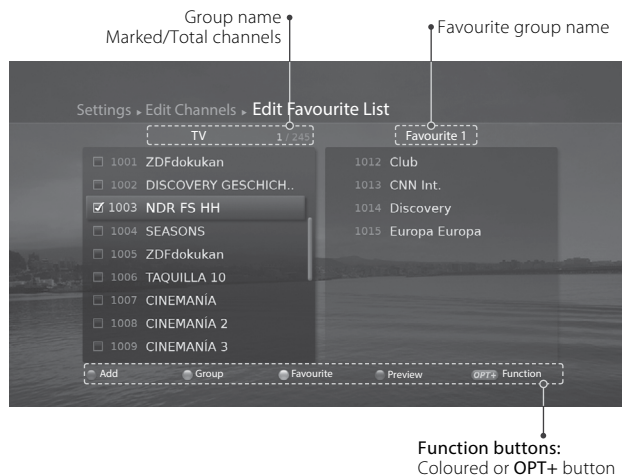

Note:

- : Locked channel, : Scrambled channel (CAS icons)
- Press the **TV/RADIO** button to switch between **TV** and **Radio** groups.
- Press the **MENU** or **EXIT** button to exit. Press the **BACK** button to return to the previous menu.
- The channels that are automatically numbered by the broadcaster cannot be deleted or moved.
- The default password is 1234.

	<p>Adding Favourite Channels Select the channels to add using the ▲/▼ and OK button in the left column and then press the RED button. The added channels will be listed in the right column.</p> <p>Removing Favourite Channels Select the channels to remove from the right column using the ▲/▼ and OK button and then press the RED button.</p>
	<p>Changing Group To list the channels of other groups in the left column, press the GREEN button and select a group you want. (TV, Radio, HDTV)</p> <p>Moving Favourite Channels Select the channels using the ▲/▼ and OK button in the right column and then press the GREEN button.</p>
	<p>Changing Favourite Group To list the channels of other favourite groups, press the YELLOW button and select a group you want.</p>
	<p>Changing Background You can change the channel displayed in the background while editing. Select the channel you want to watch and the press the BLUE button. The background channel will change.</p>
	<p>Selecting / Releasing All Channels</p>

Changing Bouquet List

MENU > Settings > Edit Channels > Password > Change Bouquet List

Select a Bouquet from the list. If you change the Bouquet, the schedules in the previous Bouquet is deleted. The default password is 1234.

TV Guide

You can access the TV guide in several ways.

- Press the **GUIDE** button.
- Press the **MENU** button and select **TV Guide**.

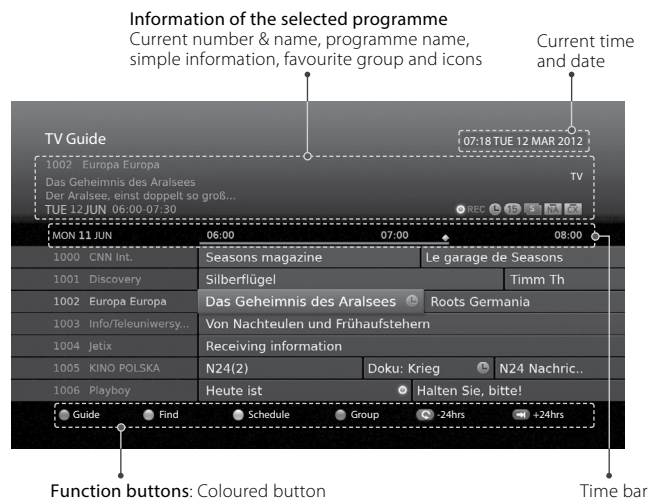

Note:

- Press the **i** button to view the detailed programme information.
- : Scheduled programme (Red: Record, Blue: Reminder),
- : Recording programme, : Present time
- : Series recording
- You can skip -24 hours/+24 hours by pressing / .

Watching Programmes

1. Select a programme and press the **OK** button. The programme will display in the preview.
2. Press the **OK** button again to exit the TV guide and watch the programme.

Setting Reminders or Recordings

Note: Setting recordings is available only when the HUMAX HDD Cartridge is connected to the product.

1. Select a future programme and press the **OK** button.
 2. Select **Reminder** or **Record** and press the **OK** button.
 3. Press the **OK** button again to cancel the reservation.
- The reserved programmes will be added automatically to **Schedule**.

Note:

- If the programme you wish to record conflicts with other two recording programmes, adjust the reservation appropriately.
- If the channel is locked, you will be prompted to enter your password to complete the reservation. The default password is 1234. If you have forgotten your password, please contact HUMAX Australia Customer Service.
- If a programme you wish to record is in a series, you can record the whole series.
- Setting recordings is available only when the HUMAX HDD Cartridge is connected to the product.
- Go to **Scheduling Reminders and Recordings** to reschedule reminders or recordings on the next page.

Changing Group

To list the channels of other groups, press the **BLUE** button and select a group you want.

Finding Programmes

Find will help you find the programmes more specifically according to the keyword or genre.

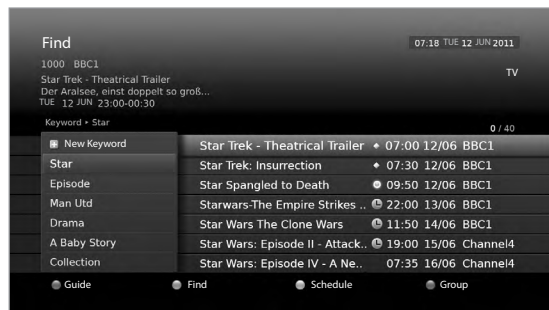

By Keyword

1. Press the **GREEN** button.
2. Select **Keyword** and press the ► button.
3. Select a keyword and press the **OK** button.

Note: To enter a new keyword, select **New Keyword**.

By Genre

1. Press the **GREEN** button.
2. Select **Genre** and press the ► button.
3. Select a genre and press the **OK** button.
4. Select the specific genre and press the **OK** button.

Note:

- Press the **i** button to view the detailed programme information.
- Press the **OK** button to watch a found programme.
- You can set reminders or recordings for future programmes.

Scheduling Reminders and Recordings

Schedule shows you the list of reminders and recordings and helps you manage them.

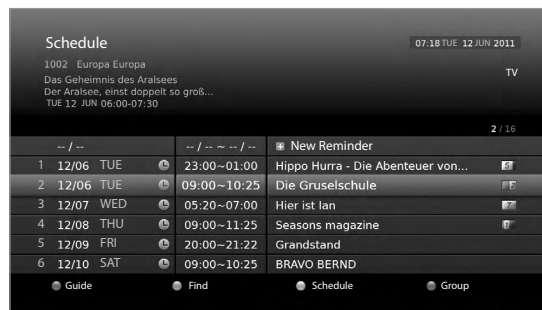

1. Press the **YELLOW** button.
2. You can add, edit or delete your reminders or recordings.
 - To add, select **New Reminder** and press the **OK** button.
 - To edit, select a reservation and press the **OK** button.
 - To delete, select a reservation and press the **BLUE** button.
3. **Reservation** will pop up. You can change the options you want using the ▲/▼/◀/▶, **NUMERIC(0~9)** and **OK** buttons.
4. Select **OK** to save and exit.

Note:

- Press the **i** button to view the detailed programme information.
- You can easily set reminders or recordings in **TV Guide**, **Find** or **i-plate** navigation mode.
- Setting recordings is available only when the HUMAX HDD Cartridge is connected to the product.

Recording

You can record programmes to the HUMAX HDD Cartridge and play back the recorded programmes whenever you want.

This function is available only when the HUMAX HDD Cartridge is connected to the product.

Detaching the HUMAX HDD Cartridge

When you connect the HUMAX HDD Cartridge for the first time, you will be prompted to format the hard disk drive or assign it for recording purpose.

1. Turn off the power.
2. Press down the HDD cartridge gently until you hear a clicking sound.
3. Keep pressing down and pull out the HDD cartridge.
4. When you want to insert the HDD cartridge back in, make sure to power off first.

Note:

- Make sure that the HUMAX HDD Cartridge is connected correctly before recording or playback.
- Please do not disconnect the HDD cartridge while recording or playing back. When the HDD cartridge is suddenly detached, the stored files or the hard disk drive may be damaged.
- Use HDD cartridges provided by HUMAX only. HUMAX is not responsible for any damages caused by connecting unauthorised HDDs.
- Recording or copying is for private and domestic use only.

Instant Recording

You can record the current programme instantly and change the recording duration.

Press the **RECORD** button to record the current programme instantly. The recording will start from the current broadcast point and the record banner will display for a few seconds. Press the **STOP** button to stop recording.

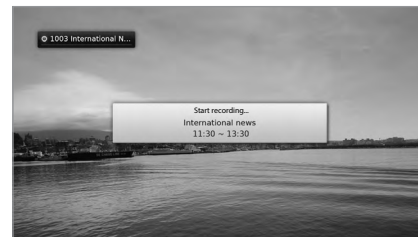

The recording will continue till the end of the current programme. However, if the programme ends within ten minutes, it will continue until the end of the next programme. When no programme information is provided, the recording will continue for two hours.

Changing Recording Duration

1. Press the **RECORD** button while recording.
2. Set the duration manually or select till the end of the current or next programme.



Scheduled Recording

You can easily set recording reservations in **TV Guide**, **Schedule** or i-plate navigation mode.



- Select a future programme and press the **OK** button in **TV Guide**.
- Select **New Reminder** and press the **OK** button in **Schedule**.
- Press the **OK** button on a future programme in i-plate and select **Record**.

The recording will start at the scheduled time and the record banner will display for a few seconds.

Press the **STOP** button to stop recording.

Note:

- Press the **GUIDE** button to go to **TV Guide**.
- Press the **GUIDE** button and press **YELLOW** button to go to **Schedule**.
- Press the **i** button while watching a programme to display the i-plate.
- Setting recordings is available only when the HUMAX HDD Cartridge is connected to the product.

Editing Recording Schedule

You can edit or delete your reservations in **Schedule**.

- To edit, select a reservation and press the **OK** button. You can change the options such as channel, date, start time, end time, repeat and mode.
- To delete, select a reservation and press the **BLUE** button.

Recording Conflict

Recording Duration Conflict

When an instant recording conflicts with one of the scheduled recordings (or reminder), you can either

- Adjust the recording duration automatically.
- Cancel the scheduled recording (or reminder).
- Cancel the current recording.

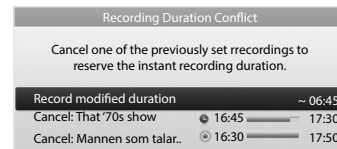

Watching Conflict

If a scheduled recording is about to start while you are watching one programme, a record notice will pop up 30 seconds before the scheduled recording starts.

- **OK** : The channel will change at the start time and the scheduled recording will start automatically.
- **Cancel** : The scheduled recording will be canceled.



Scheduling Conflict

When a new scheduled recording conflicts with one of the previously set recordings (or reminder), you will be prompted to select up to two programmes you want to keep.



Setting Recording Options

MENU > Settings > Preferences > Recording

You can set the recording padding time in case the recording starts earlier or ends later than scheduled.

- **Start Padding Time** : Additional recording time before the programme starts.
- **End Padding Time** : Additional recording time after the programme ends
- **Auto Delete**: When this option is turned on, old recordings will be deleted automatically when the HDD becomes full.

MENU >Settings>Preferences>Recording Playback

You can set the replay time or skip time for playing back recorded files.

- **Instant Replay Time**: Select the replay time
- **Skip Forward Time**: Select the skip time

MENU > Settings > Preferences > Media Playback

You can set the replay time or skip time for playing back media files.

- **Instant Replay Time**: Select the replay time
- **Skip Forward Time**: Select the skip time

Note:

- The record banner will be displayed with the i-plate whenever you press the **i** button.
- You can change the recording duration by pressing the **RECORD** button during instant recording or by going to **MENU > TV Guide > Schedule** for scheduled recording.
- The recording will continue even if you press the **STANDBY** button while recording. The scheduled recording will start even in standby mode if the HUMAX HDD Cartridge is recognized.
- While watching a recorded programme, you can trick-play using the playback control buttons such as pause, fast rewind, instant replay, slow, etc.
- You can record the digital TV or radio programmes only.
- Make sure that there is enough free space before recording. If there is no sufficient space on the hard disk drive, the recording will stop.
The space for recording a 1 hour programme may differ depending on the programme.

- To view the recorded programme list, press the **MEDIA** or **MENU** button and select **Video**.

Playback

You can playback the recorded programmes that are stored in the HUMAX HDD Cartridge.

Note:

- Make sure that the HUMAX HDD Cartridge is connected correctly before playback.
- Please do not disconnect or turn off the HUMAX HDD Cartridge drive during playback. If the HUMAX HDD Cartridge is suddenly separated or unplugged, the playback will stop and go to live TV.

Playing Recordings (Video)

You can access the recorded programme list easily and play the recorded programmes.

- Press the **MEDIA** button.
- Press the **MENU** button and select **Video**.

Select a file and press the **OK** button. Playback will start.



You can perform fast rewind, fast forward and pause while playing back a recorded programme. The green playbar is displayed when you press the playback control buttons during playback.

Playback Controls

	Play / Pause
	Stop playback and go to live TV
	Rewind
	Fast Forward
	Replay the scene
	Skip the scene

Note:

- Refer to **Media List > Using Video List** for more details about the recorded programmes.

Pausing and Rewinding Live TV (TSR)

Time Shifted Recording (TSR) allows you to pause a live broadcast and return later where you left off. TSR starts when channel is selected.

The TSR function temporarily saves the programmes you watch to the connected hard disk drive automatically.

Maximum TSR time is 120 minutes.



To pause the programme you are watching

Press the ►|| button. Press the ►|| button to return. Pause makes a time gap between the live broadcasting point and watching point. The time gap is equivalent to the period the programme has been paused.

Press the ■ button to close the time gap and go to live programme.

To rewind and watch missed scenes

Press the ◀◀ button. Press the ►|| button at the point where you want to start watching. You can pause, rewind or fast forward within the programme.

You can fast rewind back to the start point. If you reach the start point while rewinding, the programme automatically plays at normal speed.

To fast forward and skip scenes

Press the ►► button. You can fast forward only when there is a time gap between the current watching point and the live broadcasting point caused by pause, or rewind. You can fast forward up to the current broadcasting point. If you reach the live broadcasting point while fast forwarding, the programme automatically plays at normal speed.

Note: Fast forwarding and jump may not function in programmes restricted by DRM.

Media List

You can play video, music or photo files from the HUMAX HDD Cartridge, the USB storage devices or home network devices.

You can access the media list in several ways.

- Press the **MEDIA** button.
- Press the **MENU** button and select **Video, Music or Photo**.
- Connect a HUMAX HDD Cartridge or USB storage device and select the media type.



Switching Media

1. Press the **YELLOW** button.
2. Select the media type and press the **OK** button.
 - **Video, Music, Photo**

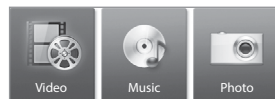

Switching Storage

1. Press the **BLUE** button.
2. Select the storage and press the **OK** button.
 - **HDD:** Displays the external HDD.
 - **USB:** Displays each partition of the connected USB storage devices. Select a USB.
 - **Network:** Displays the connected home network devices. Select a server.



Note:

- Make sure that the HUMAX HDD Cartridge, USB storage device or network is connected correctly before using Media List.
- The USB port on your product supply 1500mA. Make sure to connect the power if you use the USB storage device which requires an external power supply.
- If the USB storage device is connected in standby mode, it will automatically be recognised when the product is turned on.
- Do not disconnect the USB storage device during playback, the stored files or the USB storage device may be damaged.
- USB storage devices below USB 2.0 are supported, but they may not work properly.
- HUMAX cannot guarantee compatibility with all USB storage devices and assumes no responsibility for any loss of data.

Using the Home Network Media Server

Your receiver is a home network device capable of sharing media files with other home network devices such as the PC, NAS or another HUMAX PVR when they are connected to the same home network.

You can play the video, music or photo files that are stored in your PC on your receiver when the PC is connected to the same home network.

Connecting to Home Network

1. Connect the receiver to your home network by connecting to the router.
2. Press the **MENU** button and go to **Settings>System>Internet Setting**.
3. Set the options for the LAN or Wi-Fi. (Refer to **System>Internet Setting** for details.)

Playing Files On Your Receiver

: Files stored in the PC, NAS or another HUMAX PVR

1. Press the **MEDIA** button.
2. Press the **BLUE** button and select **Network**.
3. Select a server from the list.
4. Press the **YELLOW** button and select the media type.
5. Select the files you want to play.

Note:

- Home network media server software such as Window Media Player must be installed and executed on the PC to share media files stored in the PC. The media files must be stored in the library folder of the PC.
- Windows 7 or higher and Windows Media Player 11 or higher are recommended.

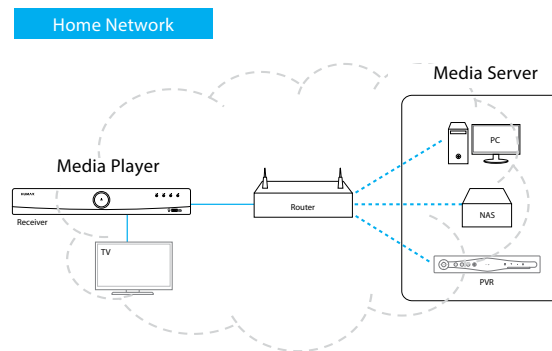

Using Video List

You can play TV/radio recordings or video files stored in the connected HUMAX HDD Cartridge, USB storage device or the home network devices.

Press the **MENU** button and select **Video**.

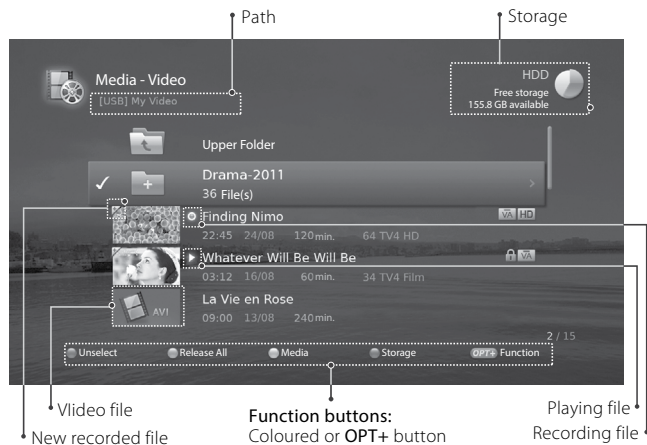

Note:

- : Recording icon, : Playing icon, : HD icon, : CAS icon, : Lock icon, : DRM (Digital Rights Management) expiration icon
- Make sure that the HUMAX HDD Cartridge, USB storage device or network is connected correctly before using Media List.
- Press the **YELLOW** button to switch the media type.
- Press the **BLUE** button to switch the storage.
- Press the **i** button to view the detailed programme information.

Playing Files

Select a file and press the **OK** button and choose **Resume play** or **Play from the start**.

To play multiple files successively, select the files using the **RED** button and press the **OK** or **PLAY** button.

You can perform rewind, fast forward and pause while playing back a recorded file. Refer to **Recording and Playback > Playback** for details on playback control and playbar.

Note:

- You will be prompted to enter the password when you play the locked files.
- Some playback control buttons may not function depending on the contents.

Editing Files



Sort	Sorting Files You can sort the video files in alphabetical or time order.
Delete	Deleting Files Select Yes and press the OK button.
Lock Unlock	Locking Files Enter the password.
Move (Copy)	<p>► Moving the files within the same storage: Select the folder you want to move the files to and press the OK button.</p> <p>► Copying the files to another storage: Select the storage and then select the folder to copy the files to.</p>
	<p>Note:</p> <ul style="list-style-type: none"> • When you move a locked file, you will be prompted to enter the password. • When you move a file to another storage, the file will be copied. You can also copy recorded programmes to another storage. (Refer to USB file system under Media List on AU20.)
Rename	Renaming Files Enter the name of the file in the keyboard and press the YELLOW button.
New Folder	Creating New Folder Enter the name of new folder in the keyboard and press the YELLOW button.

Using Music List

You can play music files stored in the connected HUMAX HDD Cartridge, USB storage device or the home network devices.
Press the **MENU** button and select **Music**.

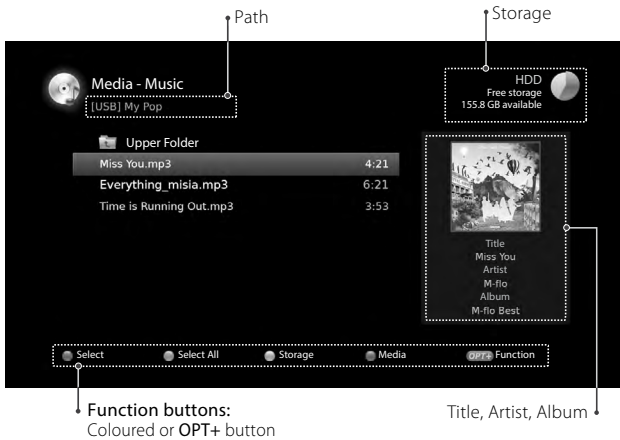

Playing Files

Select a file and press the **OK** or **PLAY** button. All files in the folder will play successively.
To play the selected files only, select the files using the **RED** button and press the **OK** or **PLAY** button.

Music Player

The music player displays during playback.

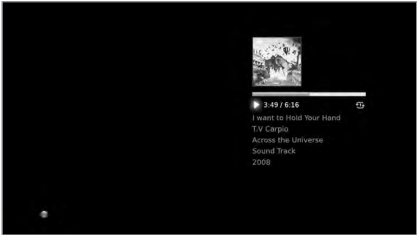

	Play / Pause
	Stop the music player and display the list
	Play the previous file
	Play the next file
	Change the play mode
	Exit the music player and go to live TV

Editing Files

You can delete, move or rename the music files. Refer to *Using Video List > Editing Files*.

Using Photo List

You can play photo files stored in the connected HUMAX HDD Cartridge, USB storage device or the home network devices.

Press the **MENU** button and select **Photo**.

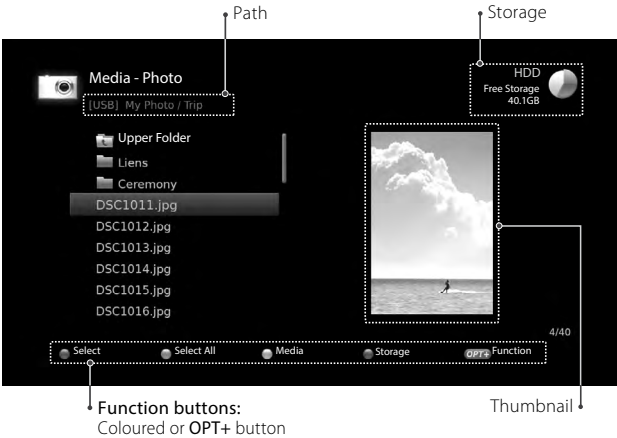

Photo Slideshow

Select a file and press the **OK** or **PLAY** button. All files in the folder will display successively.
To slideshow the selected files only, select the files using the **RED** button and press the **OK** or **PLAY** button.
The information banner displays while slideshow is paused.



	Play / Pause
	Stop slideshow and display the photo list
	Show the previous photo
	Show the next photo
	Exit slideshow and go to live TV

Slide Mode

You can play music files during slideshow.

1. Press the **OPT+** button.
2. Select **Slide Mode** and press the **OK** button.
 - **Display Time:** The duration a photo is displayed
 - **Music Play:** Select **On** to play music files during slideshow.
 - **Folder:** Select the folder the music files are located in using the **RED** button.
3. Select **OK** to save and exit.



Media List

Viewing Photo

Press the ►/|| button to pause a slideshow and display an information banner and the colour buttons.

You can change a photo using the ◀/▶ buttons.

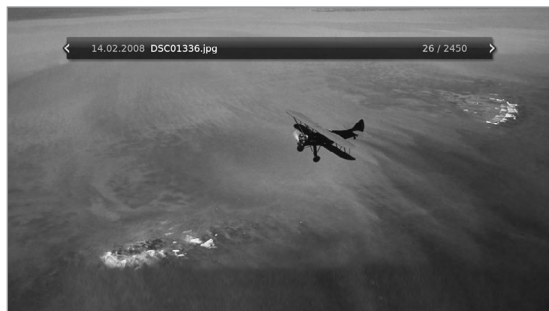

Editing Files

You can delete, move or rename the photo files. Refer to *Using Video List > Editing Files*.

HUMAX TV Portal

TV Portal is a web service portal which allows you to access various applications.

The operation of the TV Portal depends on your internet provider. TV Portal services including Catch Up TV and Video on Demand will add to your metered internet usage and may result in additional charges. Please check with your ISP provider for details of their internet plan. Please refer to the disclaimer in the next section for more details.

You can access **TV Portal** in several ways.

- Press the **TV Portal** button.
- Press the **MENU** button and select **TV Portal**.

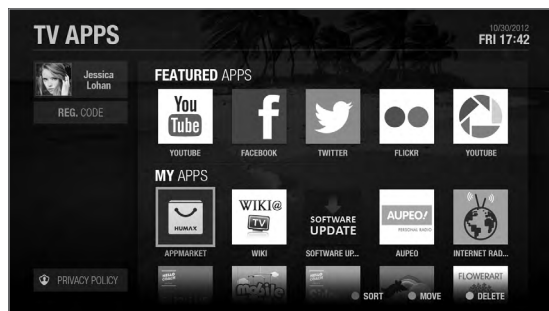

Note:

- Press the **TV Portal** button to return to TV Portal home while using the portal service.
- Press the **EXIT** button to exit. Press the **BACK** button to return to the previous menu.

Note:

- TV Portal is powered by independent service providers and the services are subject to change without notice. The services may be discontinued temporarily or permanently without further notice. HUMAX is not responsible for the content or the discontinuity of the services. Available services may vary depending on countries.
- More applications are to be updated.

Disclaimer

You agree that your use of the HUMAX TV Portal Service ("Service") is at your sole risk and acknowledge that the Service and anything contained therein, including, but not limited to, content, services, goods or advertisements (the "Items") are provided "AS IS" and that HUMAX makes no warranty of any kind, express or implied, as to the Items, including, but not limited to, merchantability, no infringement, title or fitness for a particular purpose or use. HUMAX is not responsible for the quality of the broadband, and any disruptions or discontinuation of the Services as a result of broadband provided by your Internet Service Provider ("ISP"). HUMAX does not warrant that the Service is compatible with your equipment or that the Service is free of errors or viruses and is not liable for any damage you may suffer as a result of such destructive features. You agree that HUMAX, its Suppliers and its third-party agents shall have no responsibility or liability for any injury or damages, whether caused by the negligence of HUMAX, its employees, subcontractors, agents, Suppliers or otherwise arising in connection with the Service and shall not be liable for any lost profits, losses, punitive, incidental or consequential damages or any claim against HUMAX by any other party or any fault, inaccuracy, omission, delay or any other failure in the Service caused by your equipment or arising from your use of the Service on such equipment. For any issues or questions about the compatibility with your broadband, please contact your ISP.

Preferences

MENU

- Channel List
- Video
- Music
- Photo
- HUMAX TV Portal

Settings

Preferences

- Parental Control
- Language
- Time
- Video
- Audio
- Recording
- Media Playback
- Screen Display

- Edit Channels
- Installation
- System

Parental Control

- **Restriction of Access:** You can block the programme if the programme is above the age limit.
- **Change Parental PIN:** Enter a new password.

Note:

- The default password is 1234. If you have forgotten your password, please contact HUMAX Australia Customer Service.
- Enter the password to view the blocked programmes.

Language Setting

You can set the system language.

Setting Power On/Off Timer

You can set the time the receiver powers on or powers off.

Video Setting

- **Screen Ratio:** You can select the screen ratio of your TV.
- **Display Format:** You can select the display format according to the screen ratio of your TV.
- **Resolution:** You can set the resolution of the screen.

Audio Setting

- **Digital Audio Output:** You can select the digital audio signal output.
- **Lip-Sync:** You can adjust the sound difference between audio and video.

Screen Display

- **Info Display Time:** You can set the duration the i-plate is displayed whenever you change the channel.
- **Transparency:** You can set the transparency of the On-Screen Display.
- **Subtitle Display:** You can set to display the subtitle automatically or not.
- **Subtitle Font:** You can set the subtitle font.

Search Channels [Fixed Antenna]

Installation allows you to configure your antenna and search the TV and radio channels.

MENU > Settings > Installation

- 1 Press the **RED** button and select **Fixed Antenna**.
Select **OK** to save and exit.
- 2 Select **Search Channels** and press the **OK** button.
Select **Switch Type** and select **LNB Only** or **DiSEqC**.
- 3 Select a satellite figure and press the **OK** button.
 - **Satellite:** The satellite is fixed.
 - **LNB Frequency:** Select the LNB frequency.
 - **LNB Power:** Set the LNB power On or Off.
 - **22kHz Tone:** Select the DiSEqC switch.
 - **DiSEqC:** Select the DiSEqC switch.
 - **Test Transponder:** Check the signal status of each transponder and select the one with the best quality.
Select **OK**.

Note: When **Switch Type** is set to **DiSEqC**, both **22kHz Tone** and **DiSEqC** are activated.

- 4 Select **Transponder** under the activated satellite figure and press the **OK** button.
Select a value in the transponder list.
- 5 Select **Search** and press the **OK** button. The found channels will be listed.
- 6 When the search is completed, the channel switches automatically to the most recently tuned channel.

Note:

- Select **User Define** to enter the options directly.
- All channels will be deleted if you change the antenna type.
- The default password is 1234. If you have forgotten your password, please contact HUMAX Australia Customer Service.

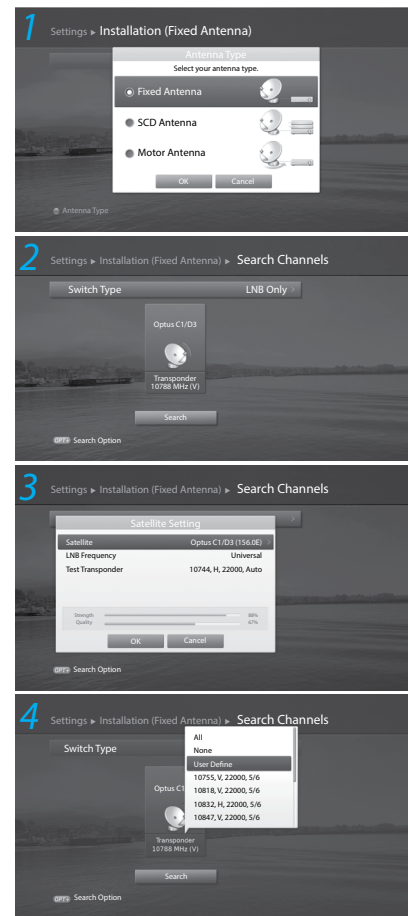

Search Channels [SCD Antenna]

Single Cable Distribution enables the delivery of broadcast programming over a single cable to multiple users eliminating the numerous cables required to support other electronics devices.

If you are using more than one satellite receiver, set one receiver at a time and turn off the others while setting. Refer to the satellite antenna manual for details.

MENU > Settings > Installation

- 1 Press the **RED** button and select **SCD Antenna**. Select **OK** to save and exit.
- 2 Select **Search Channels** and press the **OK** button.
- 3 Select **SCD Setting** and press the **OK** button to set the channel(band) and frequency for this receiver.
 - **Tuner1:** Select from Channel 1~8.
 - **Frequency:** The frequency is set based on the channel of tuner1.
 Select **OK**.
- 4 Select a satellite figure and press the **OK** button.
 - **Satellite:** The satellite is fixed.
 - **LNB Frequency:** Select the LNB frequency.
 - **Test Transponder:** Check the signal status of each transponder and select the one with the best quality.
 Select **OK**.
- 5 Select **Transponder** under the activated satellite figure and press the **OK** button. Select a value in the transponder list.
- 6 Repeat the two steps above to set more satellites.
- 7 Select **Search** and press the **OK** button. The found channels will be listed.
- 8 When the search is completed, the channel switches automatically to the most recently tuned channel.

Note:

- Select **User Define** to enter the options directly.
- Select **Stop** and press the **OK** button to stop the channel search.
- All channels will be deleted if you change the antenna type.
- The default password is 1234. If you have forgotten your password, please contact HUMAX Australia Customer Service.

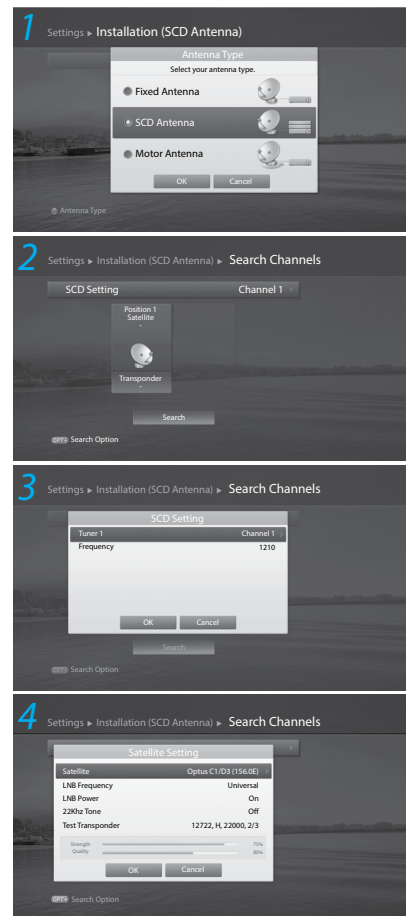

Search Channels [Motor Antenna]

You can set the position of the satellites when you use a motor antenna for efficient channel search.

MENU > Settings > Installation

- 1 Press the **RED** button and select **Motor Antenna**. Select **OK** to save and exit.
- 2 Select **Search Channels** and press the **OK** button.
- 3 Select **Motor Setting** and press the **OK** button to set the motor type and location.

• **Motor Type:**

DiSEqC1.2: General motor antenna using DiSEqC 1.2.

USALS: Motor antenna using USALS.

• **My Longitude:** Enter the longitude and direction.

• **Direction:** Select East or West.

• **My Latitude:** Enter the latitude and direction.

• **Direction:** Select North or South.

• **LNB Frequency:** Enter the LNB frequency.

Select **OK**.

Note: When **Motor Type** is set to **DiSEqC 1.2**, both **My Longitude** and **My Latitude** are inactivated.

- 4 Select **Position Setting** and press the **OK** button to set the antenna position for the selected satellites.
 - **Satellite:** Select the satellite.
 - **Transponder:** Select the transponder.
 - **Motor Driving: Continuous – Step - Time**
 - **Driving Size:** When motor driving is set to **Step** or **Time**, select one from 1~127.
 - **Go to Stored Position:** Make the antenna turn toward the position of the selected satellite. Fine-tune the position using the ◀/▶ button until the signal strength and quality reach the maximum level.
 - **Store Current Position:** Save the adjusted position.
 - **Recalculate:** Recalculates the positions of all satellites based on the position of current satellite.

Press the **BACK** button to save and return.

Note: When **Motor Type** is set to **USALS**, **Motor Driving**, **Store Current Position** and **Recalculate** are inactivated.

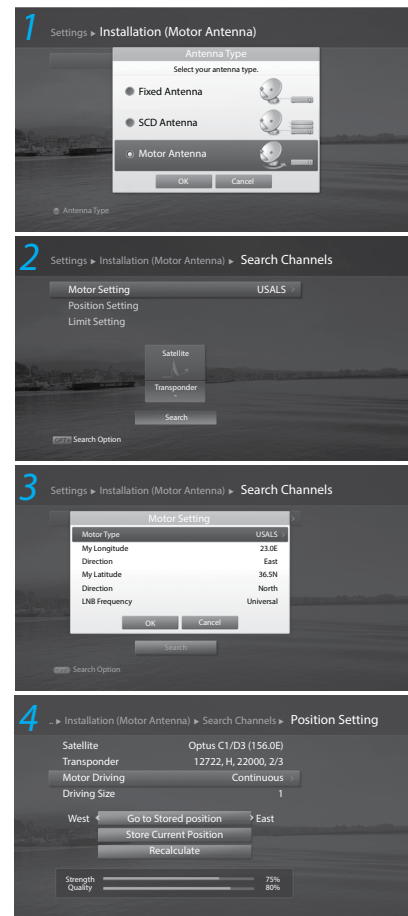



- 5 Select **Limit Setting** and press the **OK** button to set the operation limit of the motor.
 - **Limit Position:** Select **East** or **West**.
 - **Set Limit:** Set the operation limit to **East** or **West** using the ◀/▶ button.
 - **Reset Position:** Initialise the position of the motor antenna to the factory default. Press the **BACK** button to save and return.
- 6 Select a satellite you want to search.
- 7 Select **Transponder** under the activated satellite figure and press the **OK** button. Select a value in the transponder list.
- 8 Select **Search** and press the **OK** button. The found channels will be listed.
- 9 When the search is completed, the channel switches automatically to the most recently tuned channel.

Note:

- When you use a motor antenna, only the channels of one satellite can be searched.
- Repeat the search process to search more satellites.
- Select **Stop** and press the **OK** button to stop the channel search.
- All channels will be deleted if you change the antenna type.
- The default password is 1234. If you have forgotten your password, please contact your local HUMAX Australia Customer Service.

Factory Default

MENU > Settings > Installation

1. Select **Factory Default**.
2. A popup will appear. Select **Yes**.
3. You will be prompted to enter the password. Enter the password.

Note: The default password is 1234. If you have forgotten your password, please contact HUMAX Australia Customer Service.

Warning: Note that once you perform factory default, all user configured data will be reset. Shortly after you complete the factory default, the installation wizard will appear automatically.

System

MENU

- Channel List
- Video
- Music
- Photo
- HUMAX TV Portal
- Settings**
 - Preferences
 - Edit Channels
 - Installation
 - System**
 - System Information
 - Signal Detection
 - Power Management
 - IRDETO Software Update
 - Conditional Access
 - Mail Messages
 - Data Storage
 - Internet Setting

System Information

You can view the system information.

Signal Detection

You can check the signal strength and quality of the tuners.

Note: This menu is not activated during recording

Power Management

► Power Saving in Standby

Select **On** to inactivate certain functions and reduce the power consumption in standby.

► Automatic Power Down

Select **On** to enter standby mode automatically if no user interaction occurs for 3 hours.

Note: A message will display 30 seconds before the product enters standby mode. If you ignore this message, the product enters standby mode automatically.

IRDETO Software Update

You can update the software when available.

Conditional Access

You can view the Smartcard information.

Mail Messages

You can check the mail messages.

Data Storage

- **Storage:** Select a storage to display the capacity of the storage.
- **Format Storage:** Format the selected storage.

Internet Setting

Note: This function is available only when the wireless USB dongle or Ethernet cable has been connected to the receiver. Make sure that the wireless USB dongle or Ethernet cable is connected correctly. Refer to *Connecting the Network* for details.

Configuring Wi-Fi

1. Select **Configure Wi-Fi**.
2. Configure the Wi-Fi setting options.
 - **Network Name:** The Wi-Fi network name
 - **Security Type:** The Wi-Fi security type
 - **Password:** The Wi-Fi password.
3. Select **Apply** to connect to the selected Wi-Fi network and press the **OK** button.

Note: If your Wi-Fi network is not listed, select **Input Network Name** and enter your network name in the keyboard.

MENU

- Channel List
- Video
- Music
- Photo
- HUMAX TV Portal
- Settings
- Preferences
- Edit Channels
- Installation
- System
- System Information
- Signal Detection
- Power Management
- IRDETO Software Update
- Conditional Access
- Mail Messages
- Data Storage
- Internet Setting

Configuring LAN

1. Select **Configure LAN**.
2. Select your IP configuration type between **DHCP** and **Manual**.
 - **DHCP**: If you use a router or modem that has a DHCP (Dynamic Host Configuration Protocol) server function, select **DHCP**. The IP address will automatically be determined.
 - **Manual**: If there is no DHCP server on the network and you want to set the IP address manually, select **Manual**. Enter the values for IP Address, Subnet Mask, Gateway Address and DNS Address.
3. Select **Apply** to connect to the selected network and press the **OK** button.

Note:

- When entering the IP address manually, enter 3 digits in a row.
- The network is connected by LAN when both WiFi and LAN are activated.
- HUMAX recommends the network connection over a direct LAN.

Specification

Tuner & Channel	
No. of Tuners	Two tuner w/1 input
Input Connector	F-Type, IEC 169-24, Female
Frequency Range	950 MHz to 2150 MHz
Signal Level	-25dBm to -69dBm
LNB Power & Polarisation	Vertical : +13.3V (+14.3V at high voltage) Horizontal : +18.3V (+19V at high voltage) Current : Max. 500mA (Overload protection)
22kHz Tone	Frequency : 22 ± 4KHz Amplitude : 650mV ± 250mV
DiSEqC Control	Version1.0, 1.2, USALS
A/V Decoding	
Audio Mode	Single channel/Dual channel/Joint stereo/Stereo
Video Format	4:3, 16:9
Video Resolution	1080p, 1080i, 720p, 576p, 576i
Memory	
Flash Memory	NAND 128MB
RAM	512MB
Audio/Video/Data In/Out	
Video	RCA, YPbPr, HDMI/HDACP
Audio	Audio L/R, S/PDIF (Digital Audio Output)

Data In/Out	
USB	USB 2.0 Host (5V  1A, 500mA Max.)
Hard Disk	
HDD	Optional (1 detachable HDD slot @front)
Power Supply	
Input Voltage	100-240V a.c., 50/60Hz
Type	SMPS
Power Consumption	Max. 39W
Protection	Separate internal fuse. The input should be protected against lightning.
Physical Specification	
Size (w/h/d)	360mmx50mmx248mm
Weight (Net)	2.0kg
Operating Temperature	0 °C to +45 °C

Note: The specifications are subject to change without notice.

Trouble Shooting

Before contacting the customer service centre, make sure to read the tips below carefully. If the problem persists after you complete the following procedure, please contact HUMAX Australia Customer Service for further instructions.

1. No message is displayed on the front display. (The product will not switch on.)

- Check the main power cable and make sure it is plugged into a suitable power outlet.
- Check that the mains supply is switched on.
- Connect the power cable to a different power outlet.
- Check that the power switch is on at the rear of the product. (where applicable)

2. No picture

- Make sure that the product is powered on and in operation mode. (Press the STANDBY button)
- Make sure that the AV cable is firmly connected to the TV.
- Make sure that the antenna cable is properly connected to the product.
- Be sure to activate channel search.
- Check the brightness level of the TV.
- Check if the channel is currently on air.
- Make sure that STB or PVR is selected as input on the remote control.
- Make sure that the antenna setting in the menu is correct. (satellite only)

3. Poor picture/sound quality

- Make sure there is no mobile phone or microwave oven near the product.
- Keep the power cable and the RF cable apart from each other.

Note: If the antenna is covered with snow or the RF is weakened by heavy rain, the condition of the sound and picture may temporarily be poor. However, poor sound and picture quality due to weather conditions cannot be accepted as a malfunction of product.

[Satellite]

- Change the satellite dish for a larger one as this will increase the signal levels received.
- Replace the LNB with a lower noise factor in case the noise factor is too high.
- Replace the LNB with a new one in case it is damaged or out of order.
- Install the antenna in an obstacle-free place.
- Check the signal levels and adjust your antenna if the level is too low. The signal level may be affected by weather conditions.

4. No or poor sound

- Check that your AV cable is connected correctly.
- Check the volume levels of your TV set and the product.
- Check if the product or TV is on mute.
- Check audio type or soundtrack option. (where applicable)

5. Remote control does not operate.

- To control the product, the top end of the remote control should point directly towards the receiving part of the product.
- Remove and reinsert the batteries in the remote control.
- Replace the batteries in the remote control for a new set.
- Set the remote control to STB or PVR mode, if you are using the universal remote control. (where applicable)

6. Cannot make reservations.

- Check that no previous reservations are conflicting with the new reservation.

7. No password information is given.

- The default password is 1234.

8. Channel search does not work.

- [Satellite] Make sure that the antenna setting in the menu is correct.

9. Cannot update new software.

- If the product does not show a message requesting update, this means no software is available.

10. Cannot watch scrambled channels.

- Check that you have the appropriate Smartcard or CI-Module. Reinsert the Smartcard or CI-Module and make sure it initialises correctly.
- Check in the menu that the product is detecting the Smartcard or CI-Module.
- Check in the menu that you have a valid subscription to the channels you want to view.
- Make sure that the Smartcard or CI-Module is not damaged.

11. The product makes a humming noise.

- The noise is from the fan; the hard disk is operating normally.

12. Cannot record programmes. (PVR only)

- The hard disk is full. Please delete unnecessary recordings and make space for new recording.
- Check if the recording conflicts with another channel. Stop the current recording or wait until the recording is finished.
- Check that the product is switched on when the recording starts.

13. Cannot operate Time Shifted Recording. (PVR only)

- TSR may not be available during recording. Wait until the recording is finished.
- Delete unnecessary programmes and make space for new recording.

14. Cannot playback. (PVR only)

- To playback the recorded file of a scrambled channel, use the Smartcard. In case it has been a long time since you last recorded, this may not work. Contact Humax Australia Customer Service.
- The signal during recording may be weak or the hard disk too full.

15. Cannot change channels while recording. (PVR only)

- Certain channels may not be changed due to restriction of the tuner or connection type.

HUMAX Australia Customer Support

Information concerning troubleshooting, software upgrade and product support is provided in the following website. Should your product require warranty service, please contact Humax Australia Customer Service.

Australia	Tel:	1300 737 937
	Opening Hours:	Mon-Fri 9:00-17:00 (excluding Public Holidays)
	Address:	7 / 602 Whitehorse Road, Mitcham, Vic, 3132
	E-mail:	ausupport@humaxdigital.com
	Website:	www.humaxdigital.com/au
	Language:	English

Error Messages

Error messages	Possible causes	What to do
No or bad signal [Satellite]	The satellite dish is not pointing at the satellite.	Adjust the dish alignment.
	Signal is too weak.	Increase the LNB voltage or connect a signal amplifier.
	Satellite dish is too small.	Change to a larger dish.
	Problem with LNB	Change the LNB.
	Wrong antenna setting	Set the antenna correctly.
The channel is scrambled or not available.	The channel has a signal but no audio or video.	Check if the channel is currently on air. Please contact the broadcasting company.
	The channel has been deleted by the broadcasting company.	Check if the channel is currently on air. Please contact the broadcasting company.
	The channel is for data broadcasting.	Remove the channel from the channel list and check for new transponder details.
The audio is not available.	The channel has a video signal but no audio.	Press the audio button to confirm that the channel has audio options.

Error messages	Possible causes	What to do
No access	No access	Make sure you have a subscription to the channel.
	No authorisation	If the product has been in standby or power off for a long time, please wait for authorisation. It may take up to 60 minutes.
No card inserted	Smartcard is not inserted.	Insert the Smartcard.
Incorrect card	Wrong Smartcard is inserted.	Insert the correct Smartcard.
	Smartcard is not inserted correctly.	Remove the Smartcard and reinsert it.
	Smartcard is damaged.	Contact your Smartcard retailer or channel broadcaster and ask for replacement.
CI-Module not installed	CI-Module not installed CI-Module is not inserted.	Insert the CI-Module.
	CI-Module is not inserted correctly.	Remove the CI-Module and reinsert it.
	CI-Module is not recognised.	Insert another CI-Module to check if the current one is working.
Invalid CI-Module	Wrong CI-Module	Insert the correct CI-Module.
	CI-Module is damaged.	Replace the CI-Module.
The antenna cable is short-circuited. [Satellite]	LNB cable is short.	Replace the LNB cable.
	LNB is internally short.	Replace the LNB.
	Alien substance is inserted into the LNB IN port. The port may be damaged.	Remove the alien substance and contact the service centre if the port is damaged.

Using the Universal Remote Control

Setting the Universal Remote Control

Set up the universal remote control so that you can control your TV with this universal remote control.

1. Select the mode (PVR, TV) you want to set by pressing the corresponding button on the remote control. The button will blink once.
2. Keep pressing the button for 3 seconds until the button lights on.
3. Enter the 3-digit code. Every time a number is entered, the button will blink. When the third digit is entered, the button will blink twice.
4. If a valid 3-digit code is entered, the product will power off.
5. Press the **OK** button and the mode button will blink three times. The setup is complete.
6. If the product does not power off, repeat the instruction from 3 to 5.

Note:

- When no code is entered for 20 seconds, the universal setting mode will switch to normal mode.
- Try several setting codes and select the code that has the most functions.

Setting the Code Randomly

1. Select the mode (PVR, TV) you want to set by pressing the corresponding button on the remote control. The button will blink once.
2. Keep pressing the button for 3 seconds until the button lights on.
3. Press the [PAGE+/CH+] or [PAGE-/CH-] key randomly until the mode button blinks.
4. When the valid 3-digit code is found, the mode button will blink twice and the product will power off.
5. Press the **OK** button and the mode button will blink three times. The setup is complete.
6. If the product does not power off, repeat the instruction from 3 to 5.

Finding Out the Code

You can find out the 3-digit code of the TV universal code that is active.

1. Select the mode (PVR, TV) you want to set by pressing the corresponding button on the remote control. The button will blink once.
2. Keep pressing the button for 3 seconds until the button lights on.
3. Press the **INFO** button.
4. The 3-digit code number will blink starting from the 3rd digit.

Button	TV
VOL+	VOL+
VOL-	VOL-
	INFO, OSD; DISPLAY
LIST	
P+	P+
P-	P-
TEXT	TEXT
SUB	SUBTITLE, LANGUAGE; CC
TV/RADIO	TV/DTV, AT/DTV; D/A; DTV/TV; DTV; DIGITAL
OPT+	
	TEXT SUBPAGE TEXT TIME
	TEXT INDEX
	TEXT POSITION TEXT CANCEL; TEXT UPDATE
SOURCE	SOURCE, AV, 55INPUT; TV/AV
SLEEP	SLEEP
V-FORMAT	TEXT SIZE; TEXT EXPAND; FTB
WIDE	WIDE, FORMAT, 16:9, ASPECT; ZOOM

Appendix

Brand	Code
Acer	261, 278, 305
Acoustic Solutions	210, 312, 324, 370, 386, 428, 477
Akai	102, 006, 098, 144, 145, 111, 061, 043, 074, 148, 232, 280, 128, 122, 461, 109, 462, 489, 094, 084, 083, 065, 035, 034, 033, 028, 023, 011, 004, 002, 154, 321
Alba	006, 144, 134, 204, 087, 064, 036, 005, 108, 473, 455, 447, 388, 099, 084, 077, 072, 065, 059, 034, 023, 002
Bang & Olufsen	014
Beko	006, 144, 086, 145, 111, 064, 072, 172, 361, 405
BenQ	223, 328, 329
Black Diamond	444, 204, 211
Brionvega	006, 014, 062
Bush	102, 006, 144, 134, 204, 138, 087, 061, 043, 036, 005, 108, 376, 373, 370, 361, 355, 352, 327, 388, 430, 431, 432, 440, 448, 451, 473, 476, 477, 478, 002, 033, 035, 044, 045, 056, 059, 065, 066, 095, 133, 164, 210, 213, 229, 232, 250
cello	397, 410, 418, 419, 420
Crown	006, 144, 134, 204, 086, 145, 087, 111, 143, 064, 361, 135, 072, 071, 053, 033, 002
Daewoo	102, 006, 124, 444, 036, 441, 406, 341, 338, 271, 249, 195, 192, 190, 164, 133, 119, 091, 079, 066, 035, 034, 002
Dell	235, 278
DMTech	260, 438, 449, 454, 456
Ferguson	006, 120, 098, 103, 030, 204, 012, 020, 029, 046, 052, 054, 077, 292, 447, 476
Finlux	102, 006, 144, 145, 333, 327, 172, 122, 118, 094, 089, 084, 083, 070, 055, 035, 023, 018, 017, 014, 011, 010
Fujitsu	002, 011, 032, 035, 042, 137, 173, 187
Fujitsu General	002, 032, 035, 137
Fujitsu Siemens	172, 211, 230, 246, 268, 369
Funai	144, 134, 043, 275, 336, 369, 407

GoldStar	006, 144, 145, 111, 061, 001, 007, 020, 023, 027, 034, 035, 047, 067
Gooding	087
Goodmans	102, 006, 120, 144, 103, 134, 124, 444, 204, 087, 043, 036, 005, 478, 211, 232, 477, 250, 476, 271, 445, 355, 370, 373, 440, 376, 382, 383, 386, 002, 004, 011, 035, 047, 052, 054, 065, 066, 084, 091, 094, 119, 121, 133, 172, 195, 210
Graetz	144, 087, 061, 023, 053, 065, 211
Grundig	102, 006, 030, 087, 142, 005, 108, 498, 476, 448, 447, 445, 430, 405, 370, 271, 267, 250, 225, 135, 121, 010, 101, 096, 028, 077
Grunkel	211
Hannspree	262, 263, 264, 342, 401, 402, 463
Hantarex	006, 002, 094, 190, 260, 289
Hinari	006, 043, 036, 005, 002, 033, 059, 077, 443
Hisense	102, 092, 165, 254, 265, 366, 491
Hitachi	006, 098, 124, 204, 208, 005, 019, 037, 146, 152, 153, 163, 169, 193, 197, 007, 206, 210, 217, 227, 295, 296, 330, 377, 399, 424, 483, 020, 021, 023, 027, 035, 054, 056, 060, 076, 081, 083, 084, 085, 089, 091, 094, 018, 106, 107, 011
Humax	505, 299, 506, 507, 245, 319, 322, 411, 433, 479
Hyundai	164, 190, 192, 241, 244, 271, 291, 317, 338, 340, 341, 439
Inno Hit	036, 002, 011, 035, 045, 047, 094, 211
Irradio	006, 036, 002, 047, 065, 147
JVC	111, 036, 005, 129, 130, 015, 029, 065, 072, 137, 149, 207, 264, 362, 408, 496
Keymat	258, 300, 398, 436, 437
Lenoir	002, 214
LG	102, 006, 144, 145, 138, 061, 064, 248, 281, 354, 367, 368, 384, 396, 416, 417, 425, 426, 215, 209, 067, 047, 035, 034, 027, 023, 002, 001, 236, 257

Loewe	006, 064, 014, 048, 093, 094, 123, 131, 167, 414, 434
Logik	204, 001, 003, 029, 162, 195, 224, 292, 376, 464, 465, 466
Logix	134, 095
Luxor	098, 204, 061, 023, 033, 035, 047, 055, 056, 060, 083, 084, 122, 211
Manhattan	006, 134, 204, 164, 192, 237, 293
Marantz	102, 006, 071, 140, 277, 317
Marks and Spencer	420
Matsui	102, 006, 144, 030, 204, 087, 005, 080, 074, 153, 195, 097, 094, 369, 445, 077, 447, 065, 059, 056, 052, 044, 035, 033, 028, 011, 008, 004, 003, 002
Mitsubishi	102, 006, 204, 005, 019, 014, 015, 027, 093, 096, 191, 311
Mivar	034, 035, 047, 048, 094, 112
NEC	005, 002, 003, 025, 035, 040, 049, 066, 140, 239, 379
Nokia	098, 113, 111, 061, 023, 033, 049, 053, 055, 056, 066, 083, 084, 089, 122
Nordmende	006, 144, 103, 030, 020, 046, 054, 242, 280, 499
Onida	207, 226
Orion	102, 006, 144, 204, 467, 458, 457, 456, 448, 445, 443, 385, 218, 195, 131, 097, 094, 077, 071, 059, 050, 049, 003
Online	006, 036
Ormond	134, 204
Orsowe	094
Pacific	102, 144, 204, 208, 077, 256
Packard Bell	254, 293
Panasonic	006, 098, 061, 129, 038, 023, 063, 094, 187, 251, 294, 353, 359, 279, 306
Panavision	006, 070
Philco	006, 064, 014, 021, 072

Appendix

Philips	102, 006, 061, 459, 435, 429, 395, 310, 302, 297, 247, 125, 110, 101, 073, 066, 054, 029, 014, 002
Phonola	102, 006, 014, 029, 034
Pioneer	006, 086, 061, 064, 020, 023, 024, 046, 073, 093, 136, 159, 233, 277, 286, 381
Pionier	086, 064, 327
Radiomarelli	006, 014, 094
Relisys	190, 192, 193, 194, 220, 221, 271, 310, 333, 338, 341, 355, 390
Saba	120, 098, 144, 103, 061, 014, 020, 023, 046, 052, 054, 090, 094, 335
Sagem	113, 080, 182, 253, 337
Samsung	102, 006, 043, 064, 108, 115, 231, 252, 276, 287, 332, 345, 350, 351, 372, 442, 474, 488, 490, 492, 228, 176, 175, 127, 095, 047, 035, 034, 033, 027, 023, 011, 009, 002
Sanyo	204, 064, 005, 019, 442, 370, 363, 358, 357, 356, 222, 200, 150, 140, 097, 053, 048, 035, 034, 033, 025, 023, 017, 011, 008, 003, 002, 240
Schaub Lorenz	098, 144, 086, 111, 061, 056, 066, 215, 256, 267
Schneider	102, 006, 144, 134, 204, 061, 208, 036, 451, 450, 293, 128, 097, 095, 065, 056, 054, 042, 035, 023, 010
SEG	006, 134, 204, 087, 043, 036, 005, 285, 211, 210, 119, 062, 056, 035, 034, 002
Sei-Sinudyne	006, 014, 032, 094, 097
Seleco	023, 032, 042, 055, 062, 065, 070, 075, 099
Sharp	005, 130, 216, 015, 029, 088, 094, 177, 274, 334, 365, 409, 166, 288
Siemens	006, 030, 028, 096, 101
SKY	006, 195, 271, 300, 307, 308, 340, 341, 342, 343, 344, 391, 400, 421
Sonoko	006, 043, 002, 035, 045
Sony	006, 301, 005, 446, 412, 393, 375, 360, 325, 255, 203, 185, 174, 058, 003
Strong	210, 211

Technika	422, 428, 465, 468, 480, 493
TechniSat	102, 131, 237
Technisson	144, 242, 361
Technosonic	102, 120, 091, 195, 256, 258, 436, 437, 451, 468
Telefunken	006, 120, 144, 103, 086, 320, 202, 105, 090, 082, 055, 054, 052, 046, 020, 016, 012, 348
Tevion	102, 006, 144, 134, 204, 208, 468, 405, 403, 376, 355, 327, 298, 246, 242, 232, 230, 172, 128
Thomson	006, 120, 103, 020, 046, 052, 054, 056, 082, 335
Toshiba	030, 204, 005, 115, 129, 092, 447, 364, 313, 304, 242, 212, 211, 183, 100, 039, 022, 020, 010, 009, 004, 236, 257
Tosumi	451
Vestel	006, 134, 204, 035, 211, 333, 370
Videocon	092
Viewsonic	307, 308, 323, 335, 349, 391, 394, 259, 331
Wharfedale	102, 006, 095, 189, 256, 327, 370, 452, 453, 477, 502
Yamaha	169, 314, 330, 184
Zanussi	032, 035

TV/VCR Combo	
Aiwa	445
Amstrad	026
Beko	086
Daewoo	444, 119
GoldStar	006
Grundig	102, 006, 030, 101, 445
Irradio	147
LG	027
Philips	102, 006
Saba	120
Samsung	442
Sanyo	442
Sharp	015
Thomson	120
United	445
TV/VCR/DVD Combo	
Grundig	448
Orion	448

If the code for your equipment is not listed, visit the following website and see **MDB1.3** for a complete list of supported codes.
(<http://www.humaxdigital.com/global/support/rcucodelist.asp>)

